

KEY PLAN

LAND MEASURING 600.0 SQ. MT. HAS BEEN ALLOTTED TO POSTAL DEPT. FOR CONSTRUCTION OF POST OFFICE AS APPROVED BY V.C. DDA DATED 8.10.85 IN FILE NO. F.26(1)84-IL AT PAGE 15/N.

ADDITIONAL LAND MEASURING 210.05 SQ. MT. ALLOTTED TO SRI AHOBILA LAXMINRISHIHA SABHA FOR RELIGIOUS PURPOSE APPROVED IN T.C. MEETING HELD ON 22.10.02 VIDE ITEM NO. 28/2002.

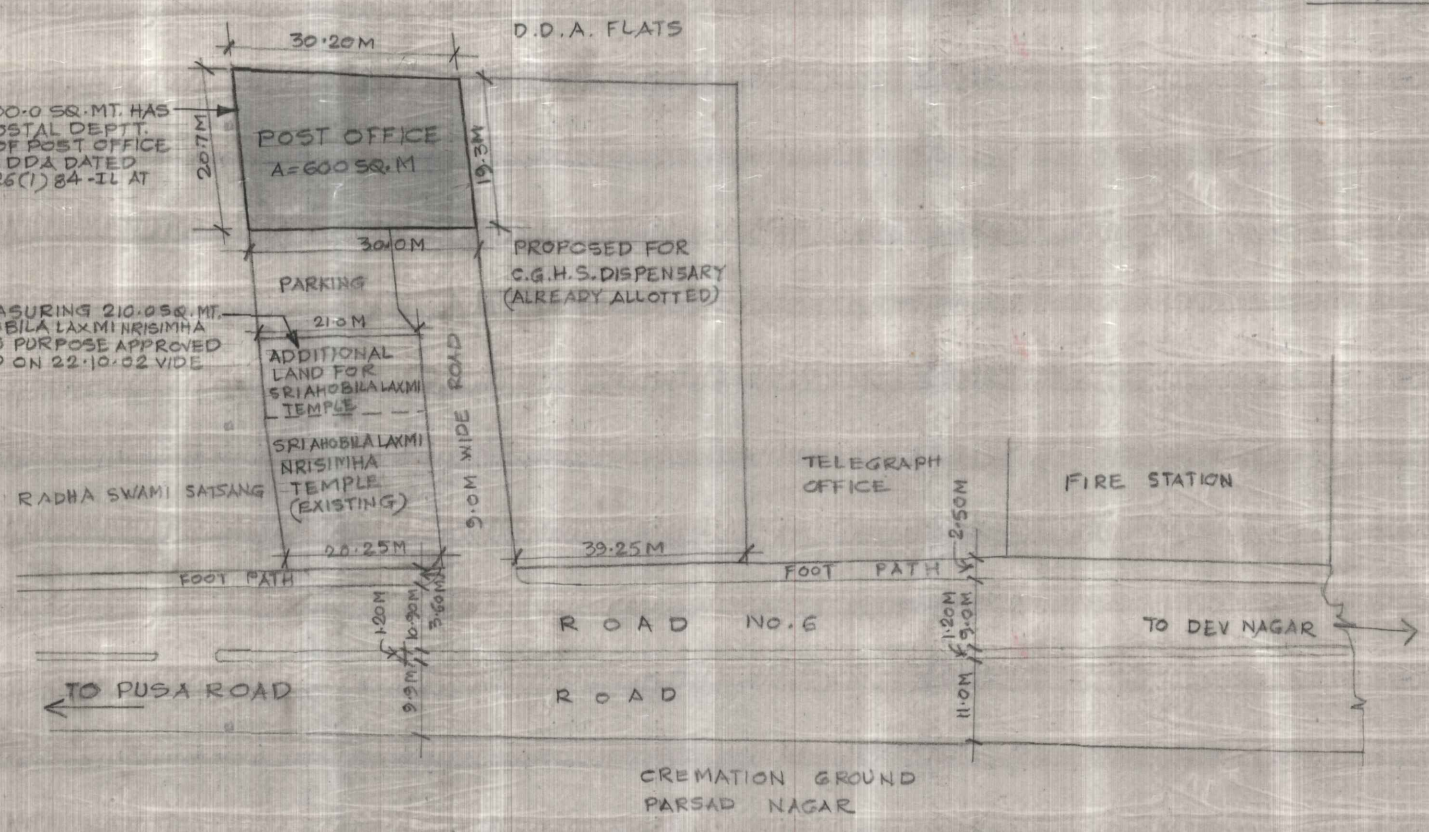

D.D.D. P-59

AREA PLANNING - I

AREA OF POST OFFICE = 600 SQ. MT.

NOTE:

1. THIS DRAWING HAS BEEN PREPARED ON THE BASIS OF P.T. SURVEY DRG. NO. W/32/05 DATED 5.7.05 RECEIVED FROM AD(3)
2. LAND MEASURING 600 SQ. MT. HAS BEEN ALLOTTED TO POSTAL DEPARTMENT FOR CONSTRUCTION OF POST OFFICE AS APPROVED BY V.C. DDA DATED 8.10.85 IN FILE NO. F.26(1)84-IL AT PAGE 15/N.
3. DEVELOPMENT CONTROLS/NORMS SHALL BE APPLICABLE AS PER MPD-2001.

B-26

POSSESSION PLAN OF LAND FOR POST OFFICE ALLOTTED TO POSTAL DEPARTMENT AT PRASAD NAGAR

SCALE 1:500	DATE: 17/02/06	DRG. NO.	NORTH
PLG. D/MAN	PLG. ASSTT.	ASSTT. DIR. (A.I.)	
BY: DIR. (A.P.I.)	DIRECTOR (A.P.I.)	ADDL. COMMFR-II	